



LB-acoustics Messgeräte GmbH

3/15/2018

update 004

## Shipments of Mysphere 3 begin:

Production of Mysphere 3 started in January, many components and sub-assemblies are made. Customers who have used the pre-order option first will now be supplied.

- A large batch of components are produced since the production start in January.
- Many sub-assemblies like the driver housing “sound frame”, head-bow, driver paddings, wiring a.s.o. are ready for final assembly according to concrete orders.
- Drivers, the key component are to be selected, carefully paired to final Mysphere 3 products.
- In-line with the received pre-orders the customers will be asked now about the concrete product variant and options they like and to turn into concrete orders.
- All products will be burned in with a special developed signal. Final testing will be done before deliveries.



*...and now something completely different...*

*We are delighted to announce the first press report about LB-acoustics and MYSPHERE 3 specifically in the FIDELITY*

*international magazin #08*

*starting on page 41*

*more to read:*

*FIDELITY international 8 is ready for free download*



## EDITORIAL



Dear friends of headphones:

This newsletter gives information about the status of product development and market introduction of headphone MYSPHERE 3

Notes includes:

- Shipments of MYSPHERE 3 start
- First press statements
- MYSPHERE at the HIGH-END Munich show
- Story of MYSPHERE “why it is as it is”

Yours truly,

Heinz Renner

Helmut Ryback

# MYSHERE at HIGH-END Munich show

The official product release  
on 10. – 13. May 2018  
MYSHERE will be presented

- at HIGH-END show in Munich
- in Hall 1 booth A4
- The stand will be divided into two areas:
- One 20m<sup>2</sup> room to enjoy the product in a closed and quiet area with several different high-end amplifiers
- One 10m<sup>2</sup> area where details such as the two-part membrane made of glass / air / resin / plastic as well as numerous other uniquenesses and the extraordinary design will be explained there

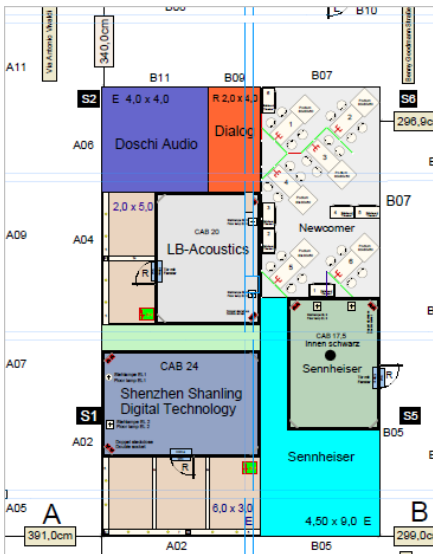

## The “Story of Mysphere”

or “**why it is as it is**”: (to be continued)

This section of the Newsletter explains the reasons for the construction and design in more detail.

### ❖ The unique head-bow construction



MYSHERE 3 uses a very different metal-bow to wear the headphone

- A light metal frame transmits the force from the soft cushions on the head over a very large area to achieve very small specific surface pressure
  - Pressure sensitive areas of the head are bypassed based on the design resulting in a well-fixed headband carrying the hovering drivers
- The need of a different construction goes back to the history when “ear-speakers” were invented first time in the 1980<sup>th</sup>
- When the AKG K1000 and the Jacklin Float was introduced to the market as products without ear cushions, the design compromise very much acoustic perfection vs. wearing comfort over time
  - Understandable because no kind of attachment around the ear was more possible due to the acoustically completely open design
- The design team which worked on MYSHERE 3 utilized the advantages of this approach using numerous 3D-measurements on heads to design a construction with the aim of providing the benefits of open design and long-term comfort
- All cushions are attached by magnets and can be removed manually without tools
  - Additionally, both drivers – the “sound frames” of the headphone can be removed without tools to facilitate the transportability and service
  - Since no human head is symmetric, all adjustments of angle and height have been accomplished without mechanical lock-in positions. A fine scaling allows for easy retrieval of personal settings
  - Of course, as with anything new, you must get used to it

Further upcoming events in USA  
at the booth of Woo Audio 7. – 8. APRIL 2018 at CanJam SOCAL in LA  
and 13. -15. APRIL 2018 at AXPONA in Chicago.